

EUROPEAN

E8

Material: cast iron and aluminium

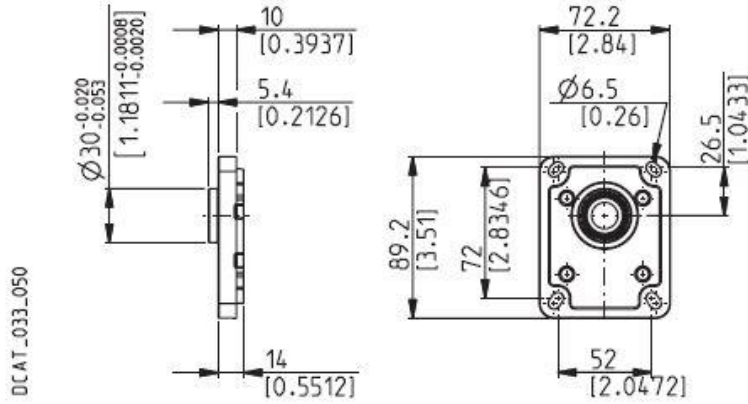

DCAT\_033\_050

Series	Pump type PLP Motor type PLM	Displacement in <sup>3</sup> /rev (cm <sup>3</sup> /rev)	Max. pressure			Max. speed	Min. speed
			p <sub>1</sub>	p <sub>2</sub>	p <sub>3</sub>		
			psi (bar)			min <sup>-1</sup>	

POLARIS 10	PL 10•1	0.07 (1,07)	3770 (260)	4060 (280)	4205 (290)	4000	650
	PL 10•1,5	0.10 (1,60)	3770 (260)	4060 (280)	4205 (290)	4000	650
	PL 10•2	0.13 (2,13)	3770 (260)	4060 (280)	4205 (290)	4000	650
	PL 10•2,5	0.16 (2,67)	3770 (260)	4060 (280)	4205 (290)	4000	650
	PL 10•3,15	0.20 (3,34)	3770 (260)	4060 (280)	4205 (290)	4000	650
	PL 10•4	0.26 (4,27)	3625 (250)	3915 (270)	4060 (280)	4000	650
	PL 10•5	0.33 (5,34)	3625 (250)	3915 (270)	4060 (280)	4000	650
	PL 10•5,8	0.38 (6,20)	3335 (230)	3625 (250)	3770 (260)	3500	650
	PL 10•6,3	0.41 (6,67)	3335 (230)	3625 (250)	3770 (260)	3500	650
	PL 10•8	0.52 (8,51)	2610 (180)	2900 (200)	3045 (210)	3500	650
	PL 10•10	0.65 (10,67)	2030 (140)	2320 (160)	2465 (170)	3500	650

STRAIGHT

29

Not available with size:

10•5,8

Mounting face refer to flange code E8

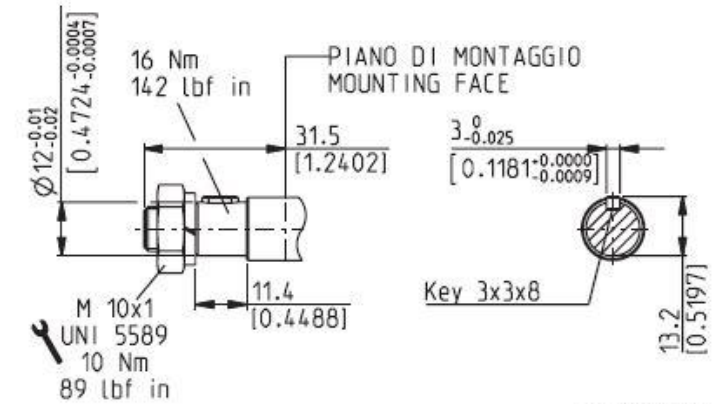

DCAT\_033\_043